



FUJIAN HOSHING PROSPER
ELECTRICAL PORCELAIN CO.,LTD

福建和盛崇业电瓷有限公司



FUJIAN HOSHING CHINA

中国·福建闽清

企业简介

闽清崇业电瓷有限公司创建于2002年5月，是市场经济造就的，主要生产高、低压电瓷的出口骨干企业。公司位于福建省闽清县梅城镇王大河工业区。

公司拥有雄厚的技术力量，有各类专业技术人员、工艺熟练、技能精干的员工和懂技术会管理的人员。公司占地面积1万多平方米，拥有先进的电瓷生产设备和生产工艺，具有完备的电瓷产品检测设备。建立和健全严密的工艺控制体系和质量保证体系。年可生产高、低压电瓷5000吨。年可出口创汇200多万美元。

公司主要生产高压线路盘形悬式瓷绝缘子，高压线路耐污盘形悬式瓷绝缘子，高、低压线路针式绝缘子，柱式绝缘子，瓷横担绝缘子，拉紧绝缘子，线轴式绝缘子，蝶式绝缘子等十多个系列近百种产品。

产品采用国标(GB)、国际电工委员会(IEC)、英国(BS)、美国(ANSI)等标准生产，生产的产品通过国家绝缘子避雷器质量监督检测中心检测。产品性能好，质量稳定。产品畅销国内二十多个省、市，远销港、澳、东南亚、中东、南美、美国、欧洲等二十多个国家和地区。

BRIEF INTRODUCTION

Fujian Hoshing Prosper Electrical Porcelain Co.,Ltd. a skeleton export enterprise specialized in the manufacture of high and low voltage electric porcelain insulators,was founded in may,2002,which is located in Wangda River Industry Area Meicheng Town,Minqing,Fujian,China

The company is abundant in technical forces,which consists of all kinds of technicians and employees who are skillful and good at management,with occupation of land over 10,000 square meters. Which owns advanced electric porcelain insulators equipments, manufacturing techniques and complete checkout equipments for electric porcelain insulators products,establishes strict technique control system and quality guarantee system.The company is able to produce 5,000 tons of electric porcelain insulators products annually,and to earn foreign currency of over USD 2,000,000 annually by exporting.

The company produces near one hundred kinds of products of over 10 series,such as cap and pin type suspension porcelain insulator for high voltage line, cap and pin type suspension antipollution type porcelain insulator for high voltage line, pin type insulator for high and low voltage line, line post insulator, ceramic bridge insulator, stay insulator, spool insulator and shackle insulator, etc.

Manufactured according to the standards of GB,IEC,BS and ANSI,the products have been passed the examination by State Insulator Arrester Quality Supervision And Inspection Center,which are proved to be with good capability and stable quality.We have a ready market in over 20 domestic provinces and cities,and also exploit the market over 20 countries of southeast Asia,middle east,south America,Europe,and U.S.A.





ANSI美标 普通盘形悬式瓷绝缘子
PORCELAIN DISC SUSPENSION INSULATORS IGENERAL TYPEI

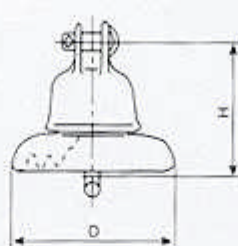

Fig1

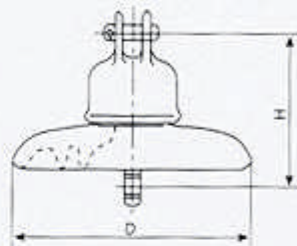

Fig2

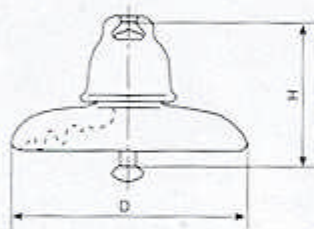

Fig3

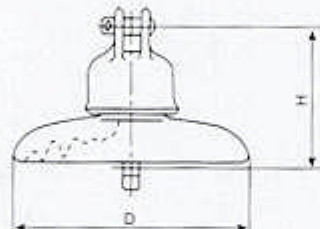

Fig4

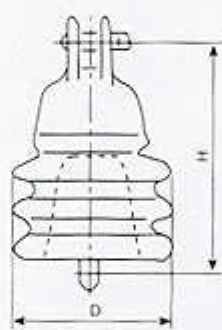

Fig5

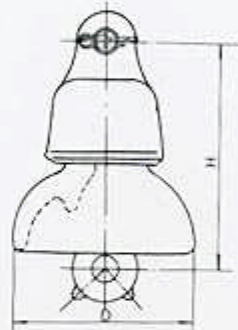

Fig6

主要尺寸和性能 MAIN DIMENSTIONS AND STANDARD PARTICULARS

美标等级 Class ANSI			52-1	52-2	52-3	52-4	52-5	52-6	52-8	52-9A	52-9B	52-10
图号 Fig.No			1	2	3	4	3	4	3	5	6	4
主要尺寸 Main dimensions(mm)	D		165	190.5	254	254	254	254	280	114	133	280
	H		140	146	146	146	146	146	146	159	159	165
泄漏距离 Leakage distance/mm			178	210	292	292	292	292	280	171	171	280
工频击穿电压 Power-frequency puncture voltage kV			80	90	110	110	110	110	110	80	80	110
平均闪络电压 Average flashover voltage	工频 Power-frequency	干 Dry/kV	60	65	80	80	80	80	80	60	60	80
		湿 Wet/kV	30	35	50	50	50	50	50	30	30	50
	临界冲击 Critical-Impulse 1.5 x 40us Wave	正极性 Positive/kV	100	115	125	125	125	125	125	110	110	125
		负极性 Negative/kV	100	115	130	130	130	130	130	90	90	130
无线电干扰电压 Radio-influence voltage	对地实验电压 Test voltage to ground/kV		7.5	7.5	10	10	10	10	10	7.5	7.5	10
	1000千赫的最大无线电干扰电压 Maximum RfV at 1000kHz/μV		50	50	50	50	50	50	50	50	50	50
额定机电破坏负荷 Rated E & M failing load/kN			44	70	70	70	111	111	160	44	44	160
例行拉伸负荷 Tension proof load/kN			22	35	35	35	55.5	55.5	80	22	22	80
打击破坏负荷 Lmpact streng/N · m			5	5.5	6	6	7	7	10	5	5	10
重量 Weight(kg)												



IEC标准 普通盘形悬式瓷绝缘子

PORCELAIN DISC SUSPENSION INSULATORS IGENERAL TYPEI



Fig1

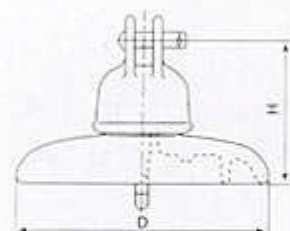

Fig2

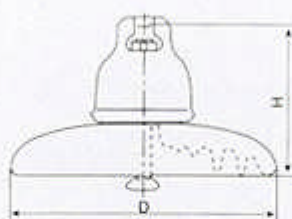

Fig3

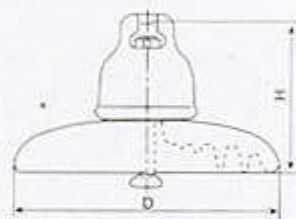

Fig4

主要尺寸和性能 MAIN DIMENSTIONS AND STANDARD PARTICULARS

绝缘子 等级 型号 Class Type (IEC)	图号 Fig.No	结构高度 (H) Unit spacing (mm)	瓷件直径 (D) Disc diameter (mm)	泄漏距离 Leakage distance (mm)	额定机电 破坏负荷 Rated E & M failing load (kN)	例行拉 伸负荷 Routine tension load(kN)	打击破坏 负荷 Impact failing load (N.m)	工频湿耐受 电压 Wet power-freq withstand voltage(kV)	雷电冲击 耐受电压 Lightning impulse withstand voltage(kV)	无线电干扰电压 Radio-influence voltage		工频击穿 电压 Power-freq puncture voltage (kV)	100只重量 Weight per 100 pcs (kg)
										对地试验电压 Test voltage to ground (kV)	最大RIV (1MHz) Max RIV at 1 MHz (μ V)		
U40B	1	110	170	190	40	20	5	30	75	7.5	50	90	
U40BP	1	110	210	295	40	20	5	35	90	10	50	90	
U70BS	3	127	255	295	70	35	6	40	100	10	50	110	
U70BL	3	146	255	295	70	35	6	40	100	10	50	110	
U70C	2	146	255	295	70	35	6	40	100	10	50	110	
U70BLP	3	146	280	440	70	35	6	42	110	10	50	120	
U70CP	2	146	280	440	70	35	6	42	110	10	50	120	
U100BS	3	127	255	295	100	50	7	40	100	10	50	110	
U100BL	3	146	255	295	100	50	7	40	100	10	50	110	
U100C	2	146	255	295	100	50	7	40	100	10	50	110	
U100BLP	3	146	280	440	100	50	7	42	110	10	50	120	
U100CP	2	146	280	440	100	50	7	42	110	10	50	120	
U120B	3	146	255	295	120	60	7	40	100	10	50	110	
U120C	2	146	255	295	120	60	7	40	100	10	50	110	
U120BP	3	146	280	440	120	60	7	42	110	10	50	120	
U120CP	2	146	280	440	120	60	7	42	110	10	50	120	
U160BS	4	146	280	315	160	80	10	40	100	10	50	110	
U160BSP	4	146	330	440	160	80	10	45	125	10	50	110	
U160BL	4	146	280	340	160	80	10	42	105	10	50	110	
U160BLP	4	146	330	525	160	80	10	45	130	10	50	110	
U210B	4	170	300	370	210	105	10	42	110	10	50	120	
U210BP	4	170	330	525	210	105	10	45	130	10	50	120	



ANSI IEC标准 耐污盘形悬式瓷绝缘子

ANTIPOLLUTION TYPE PORCELAIN DISC SUSPENSION INSULATORS

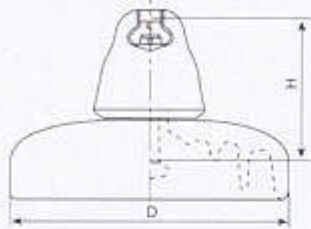

Fig1

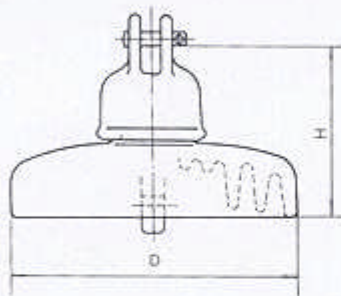

Fig2

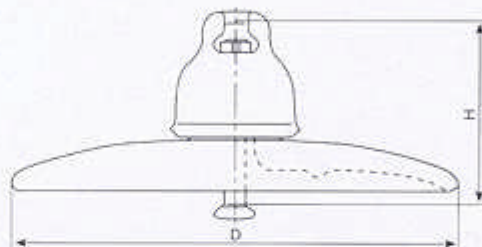

Fig3



主要尺寸和性能 MAIN DIMENSTIONS AND STANDARD PARTICULARS

产品型号 Type	图号 Fig.No	结构高度 (H) Unit spacing (mm)	瓷件直径 (D) Disc diameter (mm)	泄漏距离 Leakage distance (mm)	额定机电 破坏负荷 Rated E & M failing load (kN)	例行拉 伸负荷 Routine tension load(kN)	打击破坏 负荷 Impact failing load (N.m)	工频湿耐受 电压 Wet power-freq withstand voltage(kV)	雷电冲击 耐受电压 Lightning impulse withstand voltage(kV)	无线电干扰电压 Radio-influence voltage		工频击穿 电压 Power-freq puncture voltage (kV)	100只重量 Weight per 100 pcs (kg)
										对地试验电压 Test voltage to ground (kV)	最大RIV (1MHz) Max RIV at 1 MHz (μ V)		
XHP-70	1	146	255	432	70	35	5.6	42	120	10	50	120	
XHP-70C	2	146	255	432	70	35	5.6	42	120	10	50	120	
XHP-80	1	146	255	432	80	40	5.6	42	120	10	50	120	
XHP-80C	2	146	255	432	80	40	5.6	42	120	10	50	120	
XHP-100	1	146	255	432	100	50	6.8	42	120	10	50	120	
XHP-100C	2	146	255	432	100	50	6.8	42	120	10	50	120	
XHP,-100	1	160	280	432	100	50	6.8	45	120	10	50	120	
XHP-111	1	146	255	432	111	55.5	7	42	120	10	50	120	
XHP-111C	2	146	255	432	111	55.5	7	42	120	10	50	120	
XHP,-111	1	146	255	488	111	55.5	7	45	125	10	50	120	
XHP-120	1	146	255	432	120	60	7	42	120	10	50	120	
XHP,-120	1	146	280	450	120	60	7	45	120	10	50	120	
XHP-120C	2	146	280	450	120	60	7	45	120	10	50	120	
XHP-160	1	160	300	450	160	80	10	45	130	10	50	130	
XHP,-160	1	170	320	525	160	80	10	55	135	10	50	130	
XHP-210	1	170	300	450	210	105	10	45	130	10	50	130	
XMP-80	3	146	325	305	80	40	/	40	90	10	50	120	
XMP-100	3	146	360	300	100	50	/	40	105	10	50	120	
XMP-120	3	146	360	300	120	60	/	40	105	10	50	120	
XMP-160	3	146	360	300	160	80	/	40	105	10	50	130	



ANSI 美标 高压线路针式绝缘子
PIN TYPE INSULATORS FOR HIGH VOLTAGE

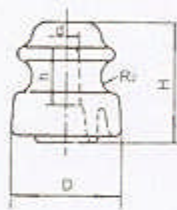

Fig1

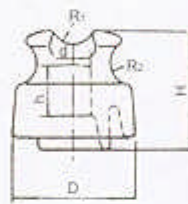

Fig2

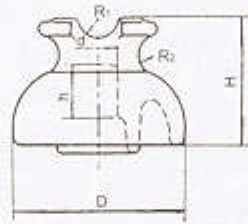

Fig3

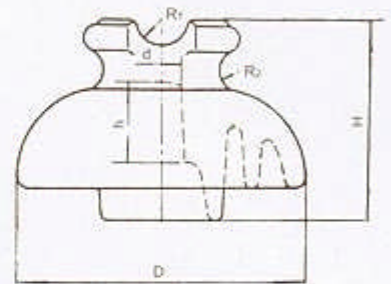

Fig4

主要尺寸和性能 MAIN DIMENSIONS AND STANDARD PARTICULARS

产品编码 Cat NO. 美标等级 Class ANSI			55-1	55-2	55-3	55-4	55-5	55-6	55-7
图号 Fig.No			1	2	3	4	4	4	4
轴型 Glaze	A: 普通型 B: 半导体轴型 A: Plain B: Radio freed		A/B	A/B	A/B	A/B	A/B	A/B	A/B
	主要尺寸 Main dimensions (mm)	H		89	82.6	95.3	111.2	123.9	140
h		44.5	38.1	38.1	44.5	50.8	57	57	
D		82.6	95.3	120.7	140	177.8	213	213	
d		25.4	25.4	25.4	25.4	25.4	25.4	35	
R1		-	16	14.3	25.4	25.4	25.4	25.4	
R2		13	16	14.3	14.3	14.3	16	16	
额定电压 Nominal Voltage/kV			3	6	10	10	15	22	22
爬电距离 Creepage Distance/mm			102	127	178	229	305	381	381
闪络电压 Flashover voltage	工频电压 Power-Frequency	干闪 Dry/kV	35	50/45	65/55	70/65	85/80	100	100
		湿式 Wet/kV	20	25	35/30	40/35	45	50	50
	50%临界冲击 50% Impulse	正极性 Positive/kV	50	75/70	100/90	110/105	140/130	150	150
		负极性 Negative/kV	70	95/85	130/110	140/130	170/150	170	170
无线电干扰电压 Radio-influence voltage	对地实验电压 Test voltage to ground/kV		5	5	10	10	15	22	22
	1000千赫的最大无线电干扰电压 Maximum RIV at 1000kHz/ μ V		2500/50	2500/50	5500/50	5500/50	8000/100	8000/100	8000/100
工频击穿电压 (最小值) Low-frequency Puncture voltage Agerage/kV			50	70	90	95	115	135	135
干弧距离 Dry Arcing Distance (mm)			57	86	114	127	159	203	203
抗弯强度 Cantilever Failing Load(lb)			3000	2500	2500	3000	3000	3000	3000
重量 Weight(kg)									



ANSI 美标 高压线路针式绝缘子
PIN TYPE INSULATORS FOR HIGH VOLTAGE

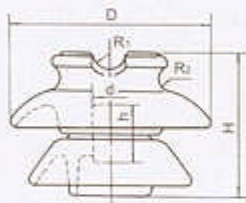

Fig1

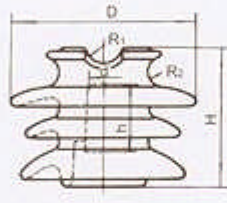

Fig2

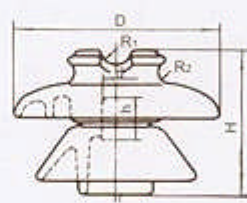

Fig3

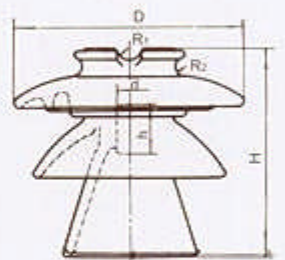

Fig4

主要尺寸和性能 MAIN DIMENSTIONS AND STANDARD PARTICULARS

美标等级 Class ANSI		56-1		56-2		56-3	56-4	56-5
图号 Fig.No		1	2	1	2	3	3	4
主要尺寸 Main dimensions (mm)	H	146	165	191	241	318		
	h	50.8	50.8	50.8	50.8	63.5		
	D	191	228	267	305	343		
	d	34.9	34.9	34.9	34.9	34.9		
	R1	19	19	19	19	19		
	R2	14	14	14	14	14		
泄漏距离 Leakage distance in		13	17	21	27	34		
干弧距离 Dry Arcing Distance in		7	8	9	11	14		
工频电压 Low Frequency Voltage kV	干闪络 Dry Flashover	95	110	125	140	175		
	湿闪络 Wet Flashover	60	70	80	95	125		
	击穿 Puncture	130	145	165	185	225		
临界冲击闪络 Critical Impulse Flashover Voltage	正极性 Positive/kV	150	175	200	225	270		
	负极性 Negative/kV	190	225	265	310	340		
无线电干扰电压 Radio-influence voltage	工频试验电压(对地有效值)kV Low Frequency Test Voltage to Ground		15	22	30	30	44	
	1000千赫的最大无线电干扰电压 Maximum RIV at 1000kHz/μV	普通型 Plain	8000	12000	16000	16000	25000	
		半导体轴型 Radio freed	100	100	200	200	200	
抗弯强度 Cantilever Strength lb		2500	3000	3000	3000	3000		
重量 Weight(kg)								



AS 澳标 高压线路针式绝缘子

PIN TYPE INSULATORS FOR HIGH VOLTAGE

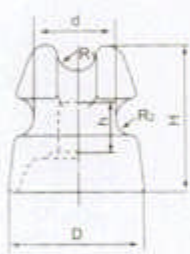

Fig1

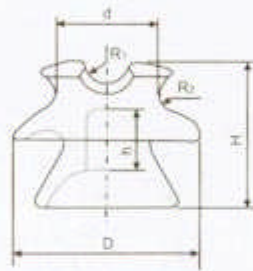

Fig2

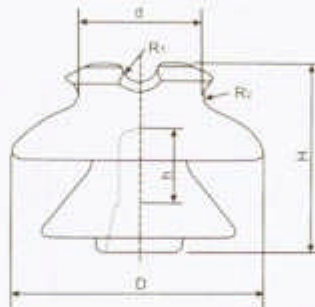

Fig3

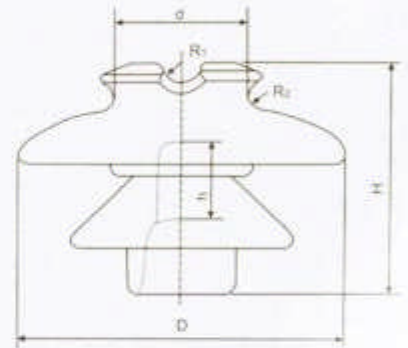

Fig4

主要尺寸和性能 MAIN DIMENSTIONS AND STANDARD PARTICULARS

Type	产品型号	LP.LV	SLP11/180	SLP22/420	SLP33/534		
Figure No.	图号	1	2	3	4		
Main dimensions 主要尺寸 (mm)	H	91	107	168	194		
	h	32.5	40	63.5	63.5		
	D	82	140	228	279		
	d	48	76	113	113		
	R1	11	16	16	16		
	R2	11	13	13	13		
Nominal Voltage	额定电压	kV	6	11	22	33	
Creepage Distance	爬电距离	mm	100	180	420	530	
Power Frequency Puncture Voltage	工频击穿电压	kV	50	95	130	165	
Cantilever failing load	弯曲破坏负荷	kN	7	11	11	11	
Minimum Flashover voltage(min) 闪络电压 (不小于)	Power Frequency Voltage 工频	Dry 干	kV	35	60	80	120
		Wet 湿	kV	20	32	60	80
	50% Critical Impulse 50%临界冲击	kV	75	95	150	170	
Net Weight	净重	kg					
Applicable standard	执行标准		AS				



ANSI 美标 高压线路柱式绝缘子
LINE POST INSULATORS FOR HIGH VOLTAGE

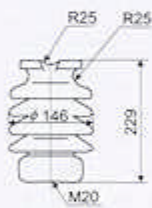

Fig1

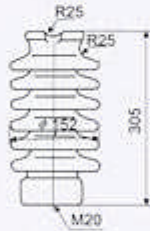

Fig2



Fig3



Fig4

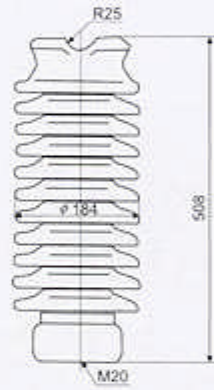

Fig5

主要尺寸和性能 MAIN DIMENSTIONS AND STANDARD PARTICULARS

Type	产品型号		57-1	57-2	57-3	57-4	57-5
Figure No.	图号		1	2	3	4	5
Creepage distance(min)	爬电距离	mm	356	559	737	1016	1143
Drying arcing distance	干弧距离	mm	165	241	311	368	430
Cantilever strength	弯曲强度	kN	12.5	12.5	12.5	12.5	12.5
Power frequency flashover voltage 工频闪络电压	Dry 干闪	kV	70	100	125	140	160
	Wet 湿闪	kV	50	70	95	110	130
Critical impulse flashover voltage 临界冲击闪络电压	Positive 正极性	kV	120	160	200	230	265
	Negative 负极性	kV	155	205	260	340	380
Radio interference voltage 无线电干扰电压	Test voltage to ground 对地试验电压	kV	15	22	30	44	44
	Max.RIV at 1 MHz 1MHZ最大无线电干扰电压	μV	100	100	200	200	200
Net Weight	净重	kg					
Applicable standard	执行标准				ANSI		



ANSI AS标准 线路用拉紧绝缘子
PORCELAIN STAY INSULATORS FOR LINES

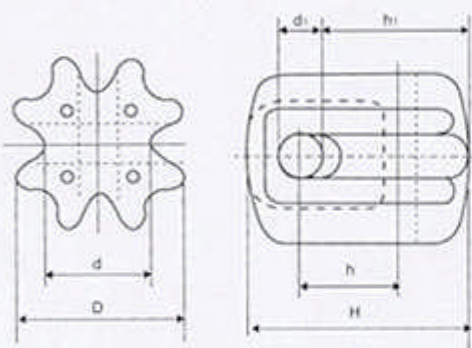

GY1

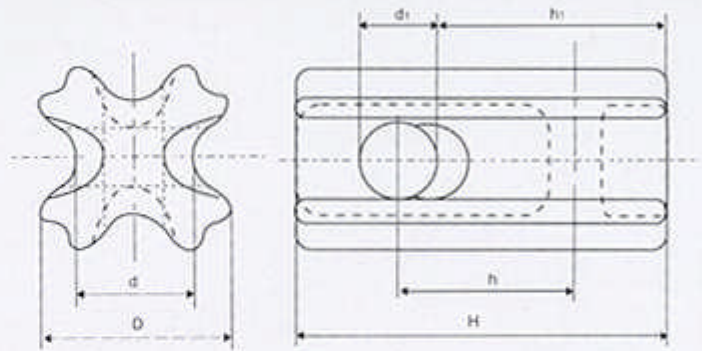

GY2 GY3 GY4

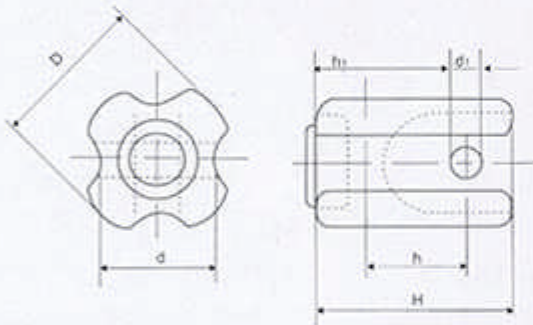

54-1 54-2 54-3

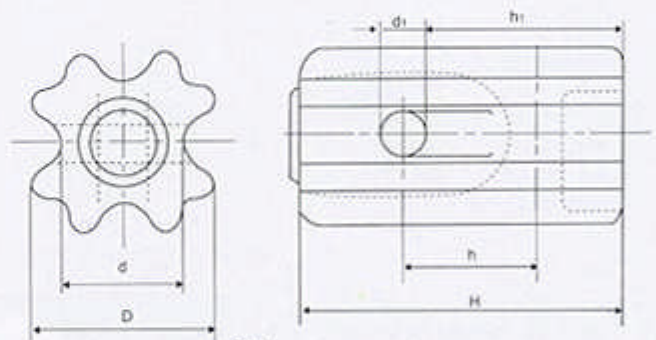

54-4

主要尺寸和性能 MAIN DIMENSIONS AND STANDARD PARTICULARS

Type	产品型号	GY1	GY2	GY3	GY4	54-1	54-2	54-3	54-4
Creepage distance 爬电距离	mm					41	48	57	76
Main dimensions 主要尺寸 (mm)	H	90	146	216	280	89	108	140	171
	h	48	73	89	89	44	57	79	67
	h1	60	99	133	165	64	76	103	114
	D	68	73	115	115	64	73	86	89
	d	10	44	67	67	44	54	60	60
	d1	16	22	38	38	16	22	25	25
Mechanical failing load 机械破坏负荷	kN	10	15	20	30	44	53	89	89
Power frequency flashover voltage 工频闪络电压	Dry 干闪 kV	27	71	222	222	25	30	35	40
	Wet 湿闪 kV					12	15	18	23
Net Weight 净重	kg								
Applicable standard 执行标准		AS				ANSI			



ANSI 美标 线轴式绝缘子

SPOOL INSULATORS

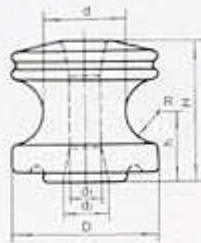

Fig1

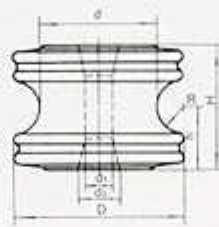

Fig2

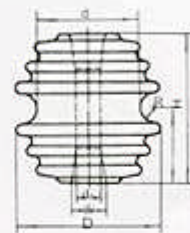

Fig3

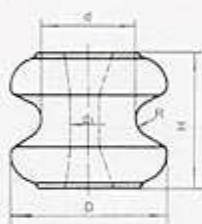

Fig4

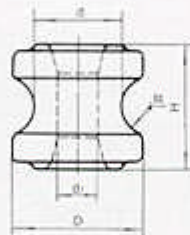

Fig5

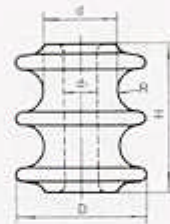

Fig6

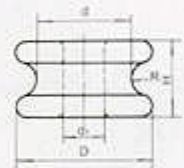

Fig7

主要尺寸和性能 MAIN DIMENSTIONS AND STANDARD PARTICULARS

产品编号 Cat.No. 美标等级 (Class ANSI)	图号 Fit.NO	主要尺寸 Main dimensions mm							机械破坏负荷 Transverse strength kN	工频闪络电 Low frequency voltage kV			重量 Weight kg
		H	h	D	d	d ₁	d ₂	R		干闪 Day flashover	湿闪 Wet flashover		
											垂直 Vertical	水平 Horizontal	
53-1	2	54	27	57	45	18	22	11	8.9	20	8	10	
53-2	1	76	38	79	45	18	24	18	13.3	25	12	15	
53-3	2	81	40.5	76	45	18	24	11	17.8	25	12	15	
53-4	2	76	38	105	73	18	24	16	20	25	12	15	
53-5	3	105	52.5	102	73	18	24	11	26.7	35	18	25	
R-8	7	32		57	40	17.5		7	9	10	7	7	
R-6	6	80		70	40	18		7	13.5	15	12	12	
R-2	5	76		80	54	17.5		17.5	20	15	12	12	
R-1	5	54		57	39	17.5		11	9	15	8	8	
1617	4	65		76	44	17.5		9	9	20	9	9	
1617-1	4	65		78	44	18.5		9	9	20	9	9	
1617-2	4	67		73	44	16		14.3	13	20	9	9	
1618-1	4	75		89	52	17		13	10	20	9	9	
1618-2	4	75		89	52	17		12.5	13	25	12	12	
1618-3	4	80		85	52	18		14	13	17	9	9	



GB标准 普通盘形悬式瓷绝缘子
PORCELAIN DISC SUSPENSION INSULATORS IGENERAL TYPEI

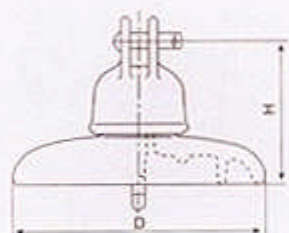

Fig1

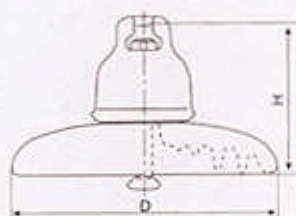

Fig2

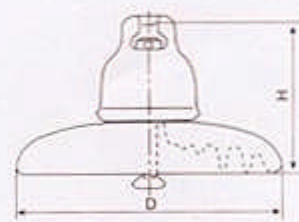

Fig3

主要尺寸和性能 MAIN DIMENSTIONS AND STANDARD PARTICULARS

型号 Type		XP-40C	XP-60	XP-70	XP-70C	XP-100	XP-160	XP-160
图号 Fit.NO		1	2	2	/	3	3	3
主要尺寸 Main dimensions	公称结构高度 H Heigh Structure Declarative	140	146	146	146	146	146	146
	瓷件公称直径D Distance Declarative Ceramic	200	255	255	255	255	255	280
连接型式标记 Coupling To Type		/	16/16C	16	16C	16	20	20
最小公称爬电距离 Minimum Greepage Distance(mm)		200	280	295	295	295	305	330
机电破坏负荷 Electromechanical Eailing Load(kN)		40	60	70	70	100	160	160
打击破坏负荷 Impact STrength(N.m)		-	-	565	565	678	1017	1017
雷电全波冲击耐受电压(峰值)不小于 Lighting Full Wave Impulse Withstand Votage(Peak)Minimum(kV)		90	100	100	100	100	100	105
工类一分钟湿耐受电压(有效值)不小于 One Minute Wet Power-Frequency Withstand Voltage(r.m.s)Minimum(kV)		30	35	40	40	40	40	42
工类击穿电压 Power-Frequency Puncture Voltage(kV)		90	110	110	110	110	110	110
参考重量 Weight(kg)								
相应老型号 The Old Models		X-3C	X-4.5	XP-7	XP-7C	XP-10	XP-16	XP-16



GB标准 耐污盘形悬式瓷绝缘子

ANTIPOLLUTION TYPE PORCELAIN DISC SUSPENSION INSULATORS

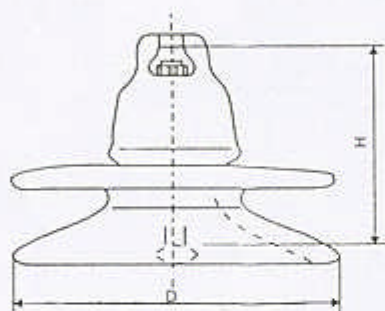

Fig1

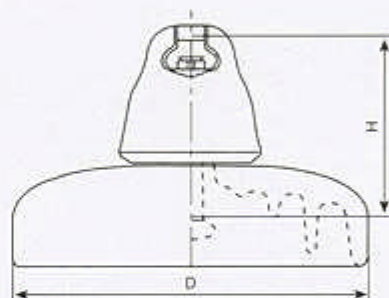

Fig2

主要尺寸和性能 MAIN DIMENSTIONS AND STANDARD PARTICULARS

产品型号 Type	图号 Fig.No	结构高度 (H) Unit spacing (mm)	瓷件盘径 (D) Disc diameter (mm)	泄漏距离 Leakage distance (mm)	额定机电 破坏负荷 Rated E & M failing load (kN)	例行拉 伸负荷 Routine tension load(kN)	打击破坏 负荷 Impact failing load (N.m)	工频湿耐受 电压 Wet power-freq withstand voltage(kV)	雷电冲击 耐受电压 Lightning impulse withstand voltage(kV)	工频击穿 电压 Power-freq puncture voltage (kV)	100只重量 Weight per 100 pcs (kg)
XWP ₁ -60	1	160	255	400	60	30	-	40	115	120	
XWP ₁ -70	1	160	255	400	70	35	-	40	115	120	
XWP ₂ -60	1	146	255	400	60	30	-	40	115	120	
XWP ₂ -70	1	146	255	400	70	35	-	40	115	120	
XWP ₃ -70	1	160	280	450	70	35	-	40	115	120	
XWP ₁ -100	1	160	255	400	100	50	-	40	115	120	
XWP ₂ -100	1	160	280	450	100	50	-	40	115	120	
XWP ₁ -160	1	160	280	400	160	80	-	45	120	120	
XHP ₁ -60	2	160	255	400	60	30	5.6	40	115	120	
XHP ₁ -70	2	160	255	400	70	35	5.6	40	115	120	
XHP ₁ -100	2	160	270	400	100	50	6.8	40	115	120	
XHP ₁ -160	3	160	280	400	160	80	10.0	45	120	120	